

SOUTH SALEM TURKEY TROT 5K

SOUTH SALEM, NY

3.106856-MI (5K)

MEASURED ON: 11/3/2015 ALONG THE SHORTEST ROUTE WITHIN THE EDGES OF THE PAVED ROADS

ELEVATIONS: START 540-FT; FINISH 540-FT;

HIGHEST 595-FT; LOWEST 500-FT

START-FINISH SEPARATION: 0-FT

MEASURED BY: GUIDO BROTHERS ESCORT SERVICE
pvolkmar@snet.net



USATF Certificate

NY15095JG

Effective: 11/04/2015 through 12/31/2025

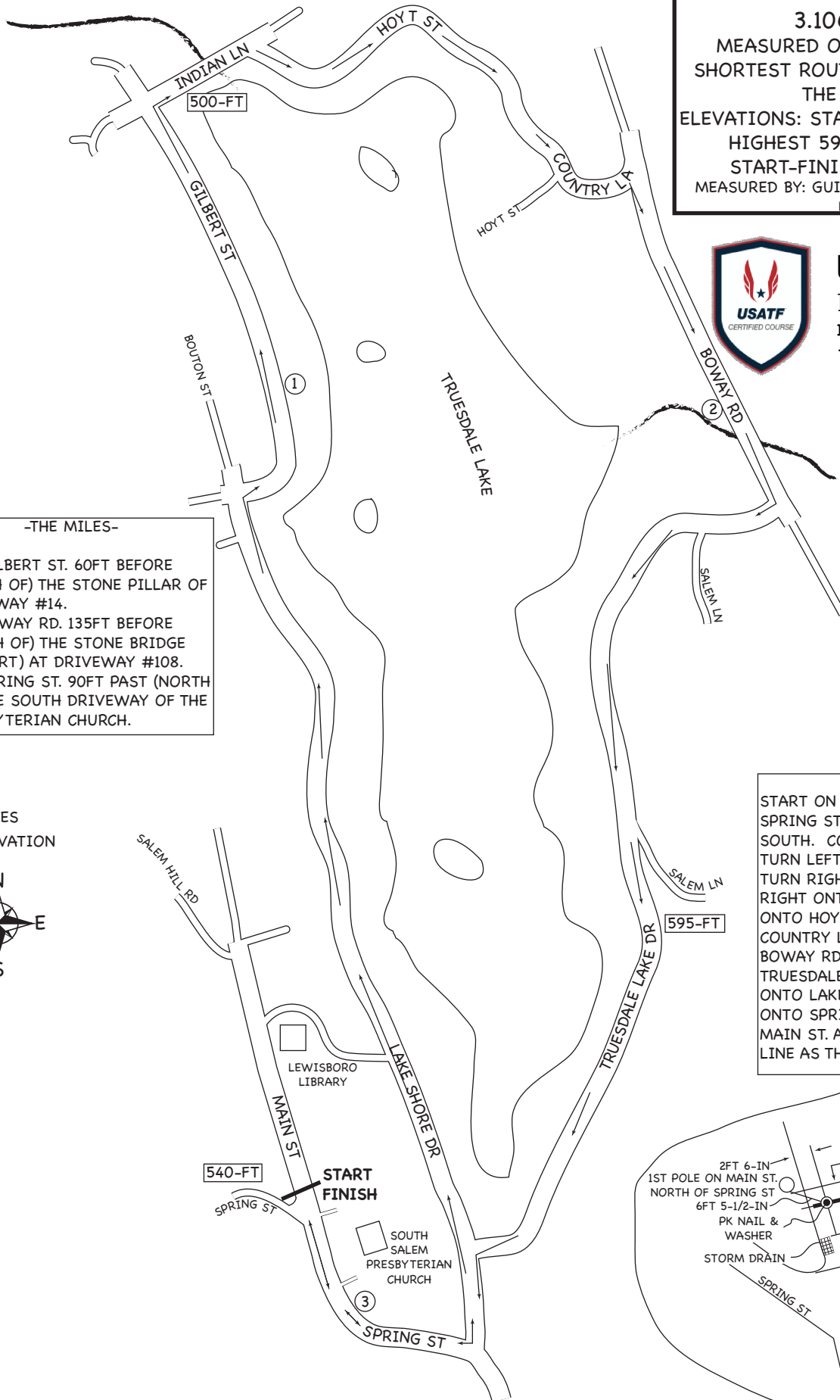

-THE MILES-

1. ON GILBERT ST. 60FT BEFORE (SOUTH OF) THE STONE PILLAR OF DRIVEWAY #14.
2. ON BOWAY RD. 135FT BEFORE (NORTH OF) THE STONE BRIDGE (CULVERT) AT DRIVEWAY #108.
3. ON SPRING ST. 90FT PAST (NORTH OF) THE SOUTH DRIVEWAY OF THE PRESBYTERIAN CHURCH.

-THE ROUTE-

START ON MAIN ST. NORTH OF THE SPRING ST. INTERSECTION, HEADING SOUTH. CONTINUE ONTO SPRING ST. TURN LEFT ONTO LAKE SHORE DR. TURN RIGHT ONTO GILBERT ST. TURN RIGHT ONTO INDIAN LN. TURN RIGHT ONTO HOYT ST. CONTINUE ONTO COUNTRY LN. TURN RIGHT ONTO BOWAY RD. TURN RIGHT ONTO TRUESDALE LAKE DR. TURN LEFT ONTO LAKE SHORE DR. TURN RIGHT ONTO SPRING ST. CONTINUE ONTO MAIN ST. AND FINISH AT THE SAME LINE AS THE START.

(M) MILES
ELEV ELEVATION

